

# Hand Rivet Squeezer Parts List

No. 10-420-1A

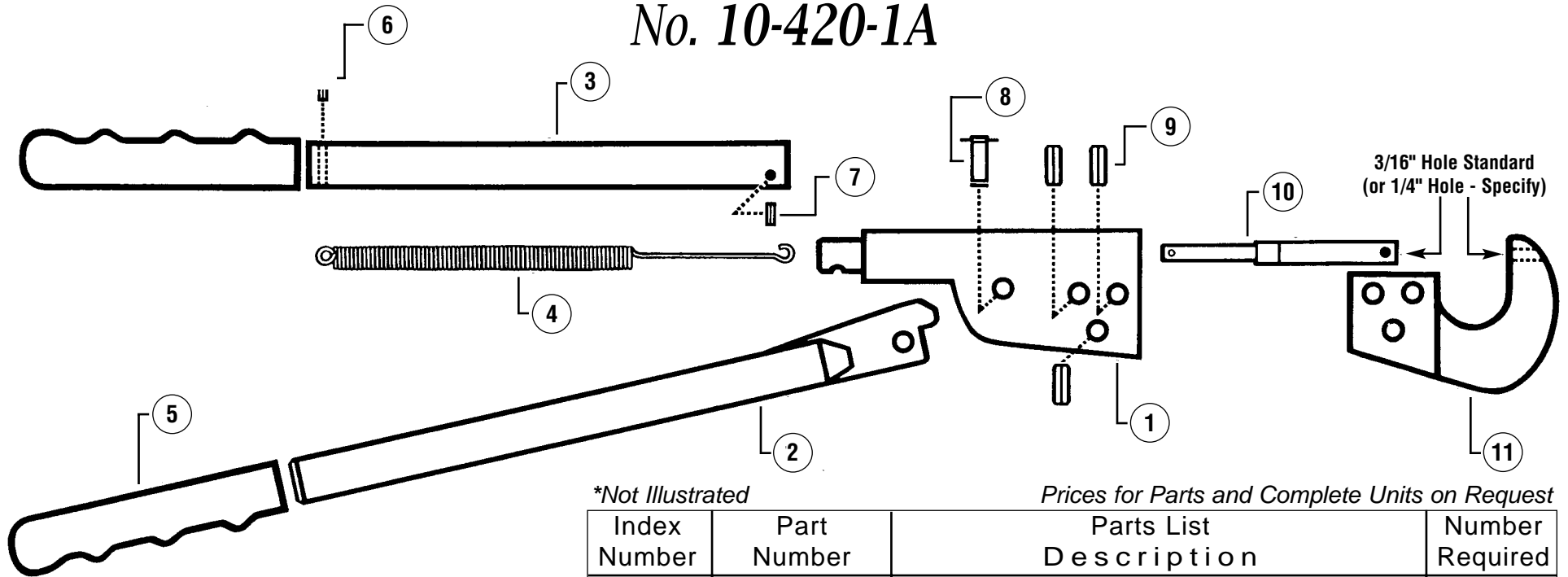

*\*Not Illustrated*

*Prices for Parts and Complete Units on Request*

Index Number	Part Number	Parts List Description	Number Required
1	38-4201	Frame	1
2	38-4202	Moveable Handle	1
3	38-4203	Stationary Handle	1
4	38-4204	Spring	1
5	38-4205	Grip	2
6	38-4206	Roll Pin (A)	1
7	38-4207	Roll Pin (B)	1
8	38-4208	Groove Pin / with 2 Retainers	1
9	38-4209	Roll Pin (C)	3
10	38-42010	**Ram / Set Holder (adjustable)	1
11	38-42011	Yoke (1" Reach)	1
*	38-42011-2	Yoke (2" Reach)	1
*	38-42011-3	Yoke (3" Reach)	1
*	38-42010NA	Ram / Set Holder (non-adjustable) -Optional	1



Eastern Division ~ Sales, Repair & Calibration

60 Fleetwood Court, Ronkonkoma, NY 11779-6951

tel: (631) 471-3300 fax: (631) 471-3308

Western Division ~ Sales & Repair

1219 W. Mahalo Place, Rancho Dominguez, CA 90220-5446

tel: (310) 632-5400 fax: (310) 632-3900

# HAND RIVET SQUEEZER

2" Yoke

Includes:  
AN470, 3/32, 1/8, and 5/32  
Cupped Sets & 2 Flat Sets

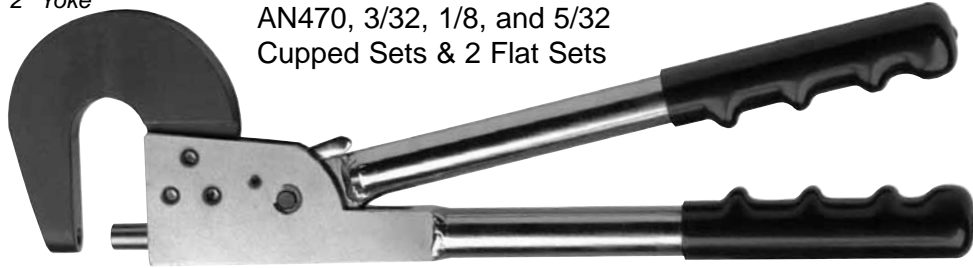

With 1" yoke installed  
No. 53-420-1A

With both 1" and 2" yokes  
No. 53-420-12A

With 2" yoke installed  
No. 53-420-2A

With both 1" and 3" yokes  
No. 53-420-13A

With 3" yoke installed  
No. 53-420-3A

With both 2" and 3" yokes  
No. 53-420-23A

With one  
each, 1", 2"  
and 3" yokes  
No. 53-420-123A

# Assorted Squeezers Rivet Sets



*Our Original Concept!*

32 Pc. Set

Virtually all the tooling you will need for your rivet squeezer. Assorted cupped, flush, soft blanks and spacer shims.

- .187 Shank
- Metal Box Included

No. 53-26

# Assorted Squeezer & Dimpling Sets

7 Pc. Set

Consists of one set (specify) Dimple Dies (male & female); AN470; 3/32", 1/8", 5/32", Two Flat Sets.

No. 53-6

# Flush Squeezer Sets



"L" Dim.	3/8" Dia.	"L" Dim.	1/2" Dia.
1/8"	26-110	1/8"	26-210
1/4"	26-111	3/16"	26-210A
3/8"	26-112	1/4"	26-211
1/2"	26-113	3/8"	26-212
		1/2"	26-213
		5/8"	26-214
		3/4"	26-215
		7/8"	26-216
		1"	26-217

# Dimple Punch & Die Kits

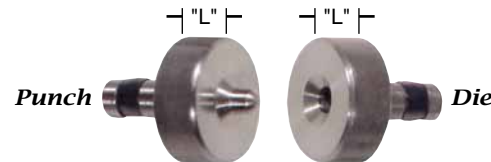

Each Kit Includes One Punch & One Die

.187 Shank

"L" Dim.	Kit No.
1/4"	53-211

For 100° Rivets (ANA426)

Rivet Sizes			
3/32"	1/8"	5/32"	3/16"
4263	4264	4265	4266

**Ordering Instructions:** Furnish dash number for rivet size.

**Example:** To order Punch & Die Kit with Body Length ("L" Dim.) of 1/4" & rivet size 1/8", order No. 53-211-4264

# 11 Pc. Adapto Hand Flaring Kit

Specially Designed for Semi-Tubular Rivets  
Ideal for Small or Prototype Runs!



Includes Flaring & Oval Tools necessary to work 1/16"-3/32", 1/8"-5/32" & 3/16" rivets.

No. 53-100-1

# Cupped Squeezers



"L" Dim.	Part No.
1/4"	26-200

# Spacer Shims

Invaluable for building up standard body length squeezer sets. Enables operator to upset rivet to the "nth" degree.



.187 Shank

"L" Dim.	Part No.
1/64"	27-0
1/32"	27-1
1/16"	27-2